

### Studio

243-281 square feet

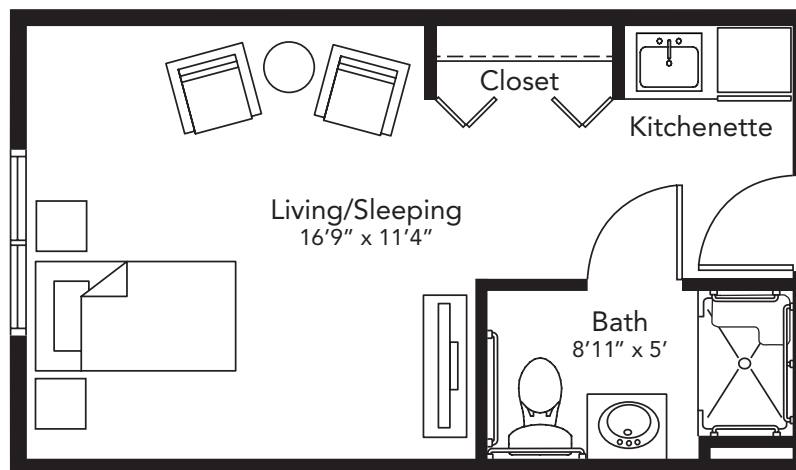

**Apartment features:** kitchenette with mini refrigerator and sink, bathroom with handicap accessible toilet, sink and shower

**Monthly fee includes:** three meals daily, electricity, heat and air conditioning, WiFi internet access, daily trash removal, property tax, one load of laundry per week, bed making and turn down service, maintenance, community and apartment security features, scheduled social activities, exercise classes, various health and personal services, emergency response systems, three comfort checks daily with staff available 24/7, licensed registered nurse access 24/7, parking

**Monthly Fee:** starting at \$3,800 • additional occupant \$600, depending on care needs

**A la carte options for additional fees:** additional laundry, additional comfort checks, condition specific medical assistance, assistance with activities of daily living, medication management, phone, cable TV, cat care service, furniture rental, non-emergency pendant use, guest apartment and meals

03/22/21